

Material: HDPE-PE4710/PE100

REVISION HISTORY		
REV	DESCRIPTION	DATE
1	VALID - ORIGINAL DWG	06/03/11
2	ADD NOTE	9/28/20
3	UPDATED TABLE SDR's	9/28/2023

Wall Thickness (T-1)								
Size	SDRs							
	7	9	11	13.5	17	21 *	26 *	32.5 *
18	2.571	2.000	1.636	1.333	1.059	0.857	0.692	0.554
20	2.857	2.222	1.818	1.481	1.176	0.952	0.769	0.615
22	3.143	2.444	2.000	1.629	1.294	1.048	0.846	0.677
24	3.428	2.666	2.182	1.777	1.412	1.143	0.923	0.738
26	3.714	2.889	2.364	1.926	1.529	1.238	1.000	0.800
28	4.000	3.111	2.545	2.074	1.647	1.333	1.077	0.862
30	4.286	3.333	2.727	2.222	1.765	1.429	1.154	0.923
32	4.571	3.556	2.909	2.370	1.882	1.524	1.231	0.985
34	4.857	3.778	3.091	2.519	2.000	1.619	1.308	1.046
36		4.000	3.273	2.667	2.118	1.714	1.385	1.108
42			3.818	3.111	2.471	2.000	1.615	1.292
48			4.364	3.556	2.824	2.286	1.846	1.477
54					3.176	2.571	2.077	1.662
63						3.000	2.423	1.938

Dimensions						
Size	Type	OD-1	OD-2	OAL	L-1	L-2
18"	IPS	18.000	21.100	19.500	8.000	3.500
20"	IPS	20.000	23.500	19.500	8.000	3.500
22"	IPS	22.000	25.600	19.500	8.000	3.500
24"	IPS	24.000	27.900	19.500	8.000	3.500
26"	IPS	26.000	29.750	19.800	8.000	3.800
28"	IPS	28.000	32.000	19.800	8.000	3.800
30"	IPS	30.000	34.000	19.800	8.000	3.800
32"	IPS	32.000	36.125	19.800	8.000	3.800
34"	IPS	34.000	38.125	20.000	8.000	4.000
36"	IPS	36.000	40.500	20.000	8.000	4.000
42"	IPS	42.000	47.125	24.000	10.000	4.000
48"	IPS	48.000	53.500	24.000	10.000	4.000
54"	IPS	54.000	59.625	37.000	16.500	4.000
63"	IPS	63.000	66.790	37.000	16.500	4.000



\* From SDR21 - SDR32.5 will be taper bore from SDR17

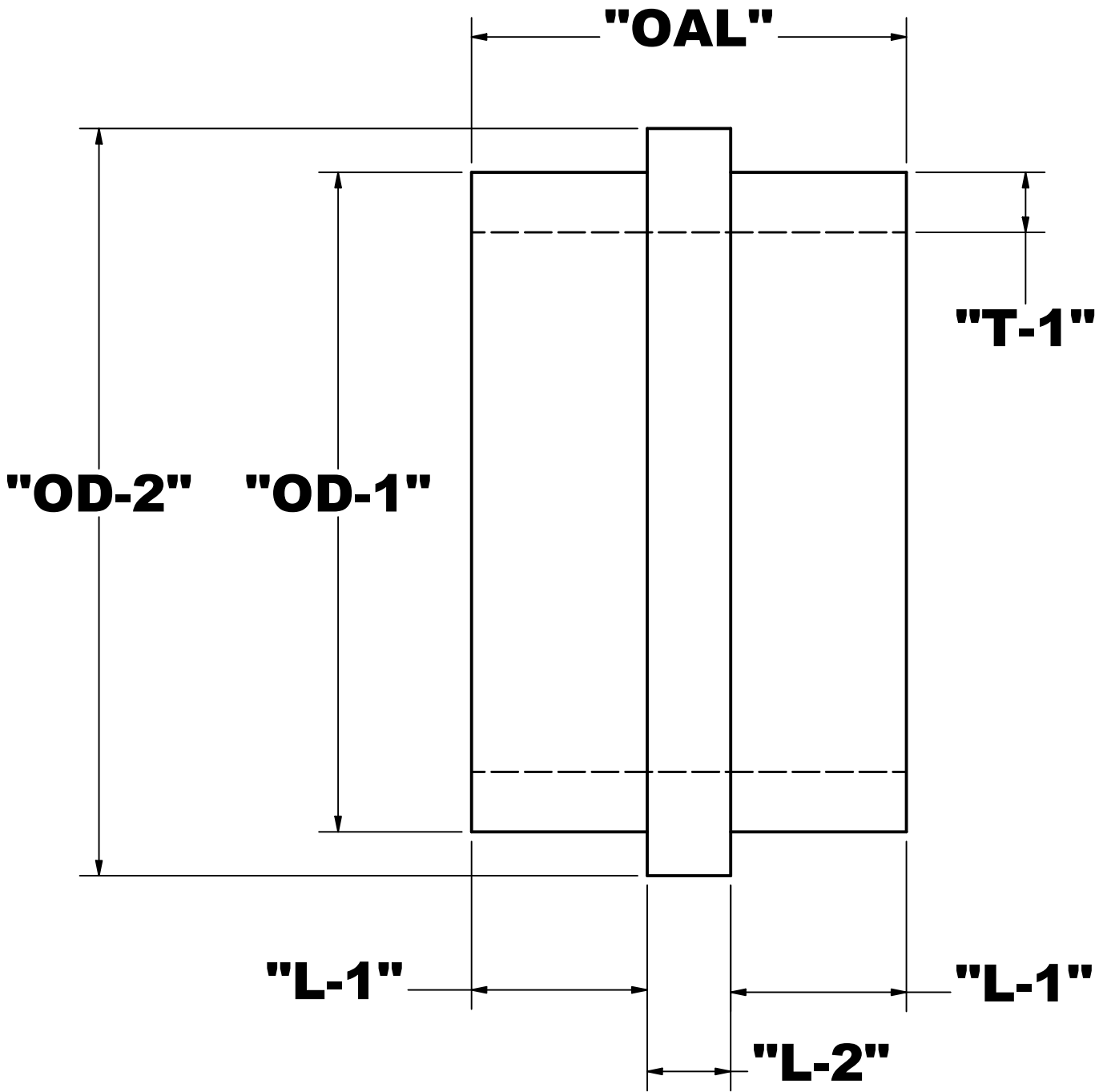

Ongoing engineering design efforts may affect the technical information listed in our publications.

Notes			
MEETS DIMENSIONAL REQUIREMENTS: ASTM D3261; AWWA C906			
	Wall Anchor Submittal - IPS		
UNLESS OTHERWISE NOTED: AND ALL DIMENSIONS IN INCHES	SIZE		